

RRIND Bracket kit Installation instructions

Replace one bracket at a time, new bracket is to replace existing bracket in the same position.

1. Remove old rear bracket and replace with new RRIND rear bracket (both brackets are the same length) in same position as the original rear bracket in the following order:

- 25mm Bolt (*Shown at the bottom on the Diagram*)
- Black washer
- Bracket
- Bar
- Nut (Use two of the supplied **Short Nuts**)

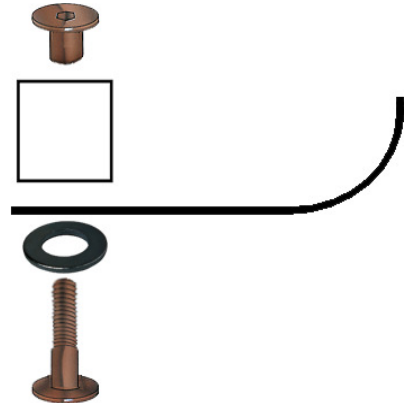

2. Tighten bracket so rear edge of bracket is flush with outside of bar.

3. Remove old front bracket and replace new RRIND front bracket (both brackets are the same length) in same position as the original front bracket in the following order:

- 40mm Bolt (*Shown at the top on the Diagram*)
- Black Washer
- Bracket
- Black Spacer
- Bar
- Nut (Use the two supplied **Long Nuts**)

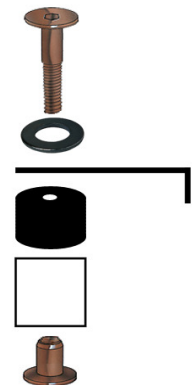

4. Tighten bracket so rear edge of bracket is flush with outside of bar.

5. Remove old lock bar and replace new RRIND lock bar in same position with the existing lock bar in the following order:

- 25mm Bolt (*Shown at the bottom on the Diagram*)
- Red washer
- Lock Bar
- Red washer x2
- Bar
- Nut (Use the last remaining **Short Nut**)

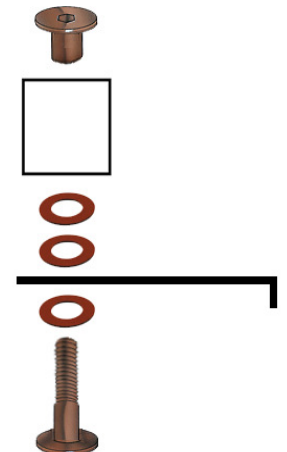

Place 2 drops of thread locker in the nut prior to installation

6. Slightly tighten Lock bar so it is firm, but can still rotate. Leave overnight to dry.

7. Test bar on roof racks for a snug fit. Move brackets in if too loose, move brackets out if too tight.